



WHOLE HOUSE DEHUMIDIFIER FOR CRAWL SPACE & BASEMENT

Guardian SN55S



Wrinkle-free tube



Optional Remote Control
(To be purchased separately)



Cable

Product Description

- ◆ The Guardian SN55S commercial dehumidifier is an effective solution to environmental control problems. This unit is of high capacity which can operate at high efficiency to remove moisture from the air through the refrigeration process. The high-efficiency rotary compressor ensures the maximum extraction with the lowest running costs. Tight spaces are no problem for the Guardian SN55S commercial dehumidifier. Its compact size works perfectly in low crawl spaces and small basements without sacrificing power or performance. Designed to fit in various small spaces, the Guardian SN55S provides multiple installation options with great flexibility.
- ◆ Guardian SN55S has the humidity sensor in bypass air design, making the short-cycling go away and quick access to internal service. Customers can do it by themselves, and service becomes easy. With excellent airflow, multiple ducting options, a side sliding filter, and some amazing engineering, the unit removes the maximum of 55 pints of water per day (AHAM) with a current draw of 4.1 Amps. It is one of the smallest and lightest dehumidifiers on the market.
- ◆ This unit is equipped with an “Auto Defrosting” defrost system, which ensures a quick and efficient clearing of ice from the coil at the minimum operating temperature of 33.8°F. The small compact size makes the unit an ideal choice for installations where space is limited i.e., crawl spaces and basements, etc.

Features

- ✓ Supper COP
- ✓ Rare Earth Alloy Tube Evaporator
- ✓ Coated Coils with Stainless Side Plate
- ✓ Quick Access for Service
- ✓ Smallest Size
- ✓ HVAC Remote System
- ✓ Engineered for low-temperature operation and the airflow issues that crawl spaces present
- ✓ Ducting options for divided spaces
- ✓ Optional remote control equipped



Automatic Defrosting System



Smallest Size



Optional Remote



Draining: Gravity Draining

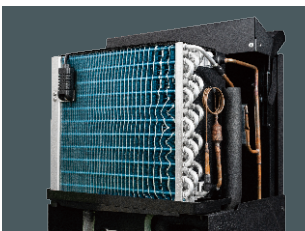

Microchannel Condenser Technology

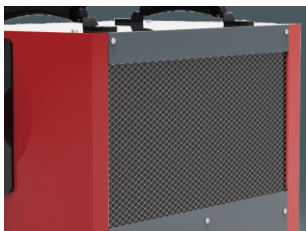

MERV-1 Filter

Specifications

Power	Size limit	Inlet Filter	Draining
4.1A (115V/60HZ)	Up to 1300 sq. ft	MERV-1 Filter	Gravity Draining
Sound level	Capacity	Functioning Temperature Range	Functioning Humidity Range
<52 dBa	55 Pints (80, 60%RH)	33.8-104°F	35~90%
Cop	Air flow	Feet	Defrosting Control System
2.4L/kWh	130 CFM, 230 CMH	Adjustable Feet	Auto Defrosting
Refrigerant	Weight	Dimensions(L*W*H)	Display type
R32	44lbs(20kg)	19.3×11.9×13.7in	Digital



Side

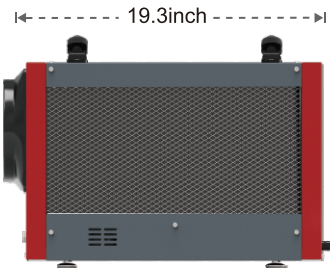

Back



Front

Application:

- ◆ Abestorm Guardian SN55S commercial dehumidifier can removal 120 PPD at saturation, 55 pints per day at AHAM, up to 1,300 sq. Ft, lowering the humidity to comfortable levels in a short period of time. This cETL-listed dehumidifier is made of a metal outer casing that withstands more rugged conditions, ensuring long-term use and easy maintenance. It can also help to resolve damage to inventory and building maintenance due to dampness. Guardian SN55S was introduced to provide a one-stop service for your humidity problem. The preassembly, external condensate connection point, and side sliding filter make the installation process simple.
- ◆ The same fit for crawl spaces & basements we designed this professional dehumidifier with the modern consumer in mind, smaller size, compact design, rugged handle, easy and safe to transport from job to job, and even from downstairs to upstairs. All special features make it the best for crawl space, basement, and commercial applications, auto defrosting system, optional remote control system, strong as the tank, low-temperature operation, cETL.
- ◆ The remote controller design makes this unit an ideal choice for places where remote sensing and controlling are required. Optional duct mounting flanges reduce the installation time when connecting to an existing/new ducting system.

- + Computer Rooms
- + Crawlspace
- + Shop/Bars
- + Museums/Sports
- + Restaurants
- + Computer rooms
- + Basements
- + Hotel/Motel
- + Offices
- + Laboratories
- + Meseums
- + Storage Areas

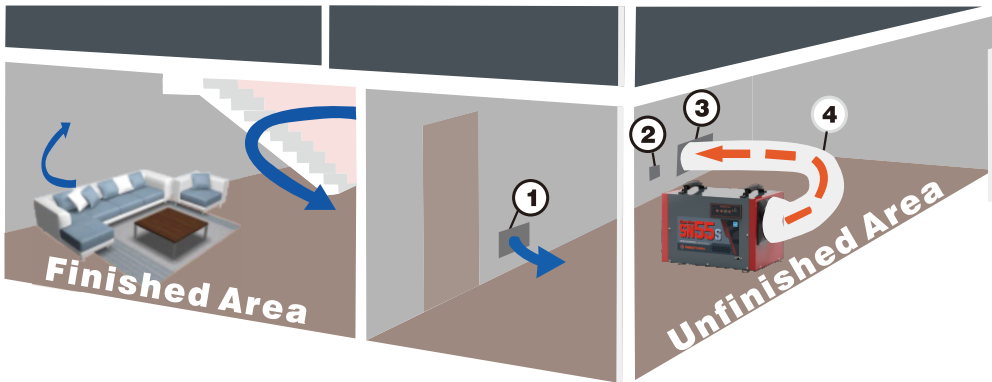

With a supply kit only:

- 1.Passive Return Vent
 - 2.Remote Control(Mounts on opposite Wall in Finished Area,Energize the sensor on Remote Control)
 - 3.Supply Grill
 - 4.Supply/Discharge Duct Work
- Place the Guardian SN55S in the unfinished area of the basement near the drain access (condensate will be drained out via gravity).
 - Connecting the Duct Tube on Collar, supply dry air from the dehumidifier to a large and open area in the finished section of the basement.
 - Place a return grill / passive vent on the other side of the wall that separates the finished and unfinished areas. This will allow circular air flow go through the basement.
 - The passive grill will prevent the unfinished room from being placed under a negative pressure and also allow the dehumidifier to focus on keeping the unfinished area dry.
 - The Remote Control has the normal retome function, to insulate the noise of unit and also can be used at the Sensor Switch. You can choose the humidity sensor from the unit and Remote Control.



The Guardian SN55S has a 5 years warranty.

Tel: (888)276-9833
sales@abestorm.com

www.abestorm.com